

# RJ45 Cat6A 10Gig Shielded Connector



**Streaming Media** whether data, audio or video, is on a sharp rise and users are demanding more bandwidth. That means bigger cable, commonly referred to as CAT6E, CAT6A, CAT7, and Industrial CAT5e. For maximum performance, connector and crimp tool choice is critical. Our CAT6A/10Gig termination system not only meets, but exceeds these requirements.

- Max cable jack OD: 8.5mm/0.335"
- Max cable conductor OD: 1.35mm/0.053"
- Exceeds 10-Gig performance standards
- Individual conductor OD range: 0.042" - 0.053" (1.07mm-1.35mm)
- Wire gauge range (AWG) 24—22
- 50µ Gold Contacts
- Works with CAT6E, CAT6A, CAT7, and Industrial CAT5e
- UL and RoHS compliant
- Connector is only compatible with our Tele-TitanXg™ and Tele-TitanXg™ 2.0 Crimp Tool.
- Designed for both shielded and unshielded cabling

## Ordering Information

### For Round Solid: 3-Prong Contact

P/N	Description	UPC Code
106190	RJ45 Cat6A 10 Gig Shielded Connector w/Liner, Solid 3-Prong. Bulk 100/Bag.	849160005155
106192	RJ45 CAT6A 10 Gig Shielded Connector, w/Liner, Solid 3-Prong. 50/Bag	849160006633
106192C	RJ45 CAT6A 10 Gig Shielded Connector, w/Liner, Solid 3-Prong. 50/Clamshell.	849160005179
106193C	RJ45 CAT6A 10 Gig Shielded Connector, w/Liner, Solid 3-Prong. 10/Clamshell.	849160006626

### For Round Stranded: 2-Prong Contact

P/N	Description	UPC Code
106195	RJ45 Cat6A 10 Gig Shielded w/Liner, Stranded. Bulk 100/Bag.	849160008354
106197C	RJ45 Cat6A 10 Gig Shielded w/Liner, Stranded. 50/Clamshell.	849160008545
106198C	RJ45 Cat6A 10 Gig Shielded w/Liner, Stranded. 10/Clamshell.	849160008552

California, USA

Phone: 805.384.2777 / 800.749.5783 • Fax: 800.749.5784

[www.platinumtools.com](http://www.platinumtools.com)

**We Make Connections EZ!™**

# 10Gig Termination Kit Instructions

# PLATINUM TOOLS

©2014 Platinum Tools Inc. All rights reserved. TS 2/14

- 1) Strip & remove 1" of your cable jacket with the Cyclops® 2 Cable Stripper (P/N 15010C). Remove cellophane and shield. Straighten the wires.

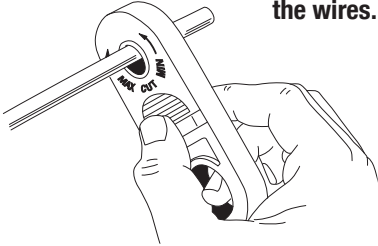

Determine whether you will be using the T568A or T568B configuration (above) and organize wires accordingly.

Wire	1	2	3	4	5	6	7	8
T568A	White/Green	Green	White/Orange	Blue	White/Blue	Orange	White/Brown	Brown
T568B	White/Orange	Orange	White/Green	Blue	White/Blue	Green	White/Brown	Brown

- 2) Line up your wires and make a clean cut across all 8 conductors and slide on the wire guide bar.

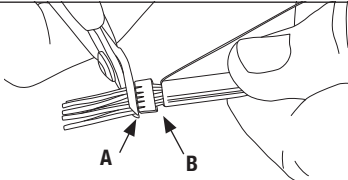

(A) Slide bar down toward end of jacket and stop when 3/16" away from the end.

(B) Flush cut across all 8 conductors at the front end of the bar.

- 3) Reshape the end of the cable using the CT-360 (PN 12360), making it oval so it slides into the connector with ease. Your wire is ready to be inserted.

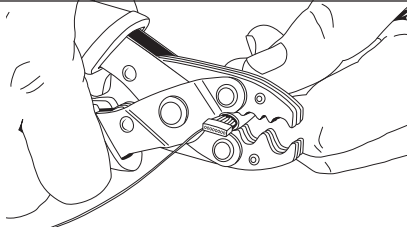

- 4) Carefully insert into backend of connector (A) and push all the way forward (B) until all 8 conductors are seated flush against the front end.

**NOTE:** DO NOT use a standard RJ45 crimp tool. This connector is designed with NO primary strain relief. Using a standard RJ45 crimp tool will crush the connector.

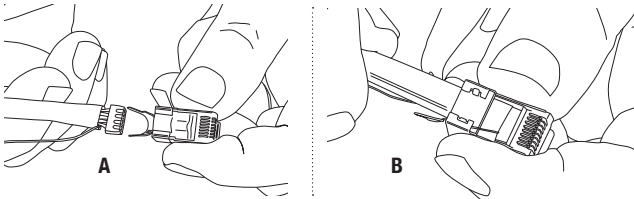

- 5) Insert the prepped connector into the proper cavity of the Tele-TitanXg (P/N 12515C) crimper. Squeeze handle to terminate.

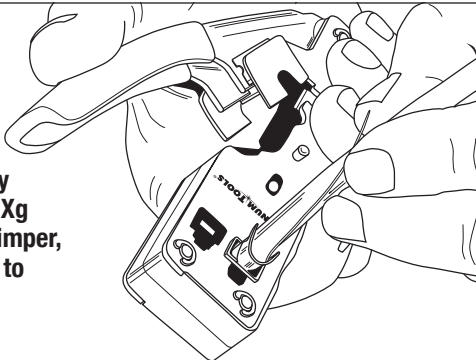

- 6) Roll up the drain wire and place in the base of the external ground. As you start to bring the external ground into place onto the cable, keep the mass of drain wire tucked in so it is totally covered.

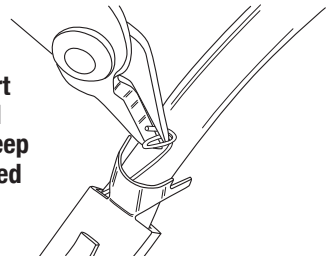

7)

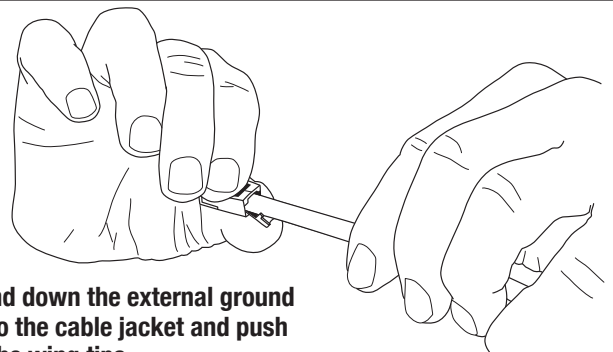

Bend down the external ground onto the cable jacket and push in the wing tips.

8)

Large Cavity

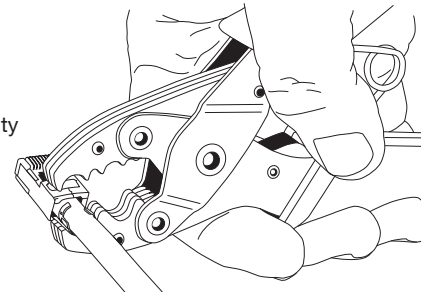

Crimp the external ground using the CT-360.

Use the large or small tool cavity depending on the size of your cable.

**NOTE:** DO NOT over crimp the external ground.

Small Cavity

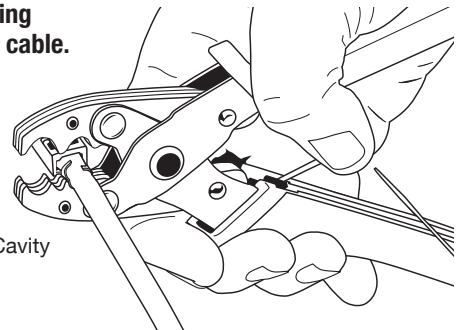

- 9) You are finished. Job well done!

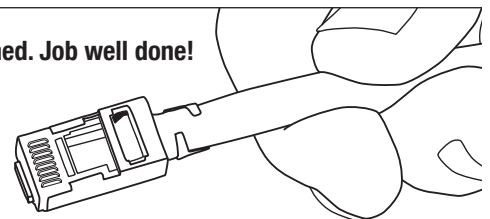

[www.platinumtools.com](http://www.platinumtools.com)