

## Unpacking

Before you begin using the device, please check the version you got and ensure that the following items are included in the shipped box:

-  X933H x 1
-  Wall Bracket x 1
-  M3 Set Screw x 1
-  M4x30 Screw x 2
-  Plastic Wall Anchor x 3
-  ST4x20 screw x 3
-  Allen Wrench x 1
-  11 Pin Cable x 1
-  10 Pin Cable x 1
-  Diode x 2

## Product Overview

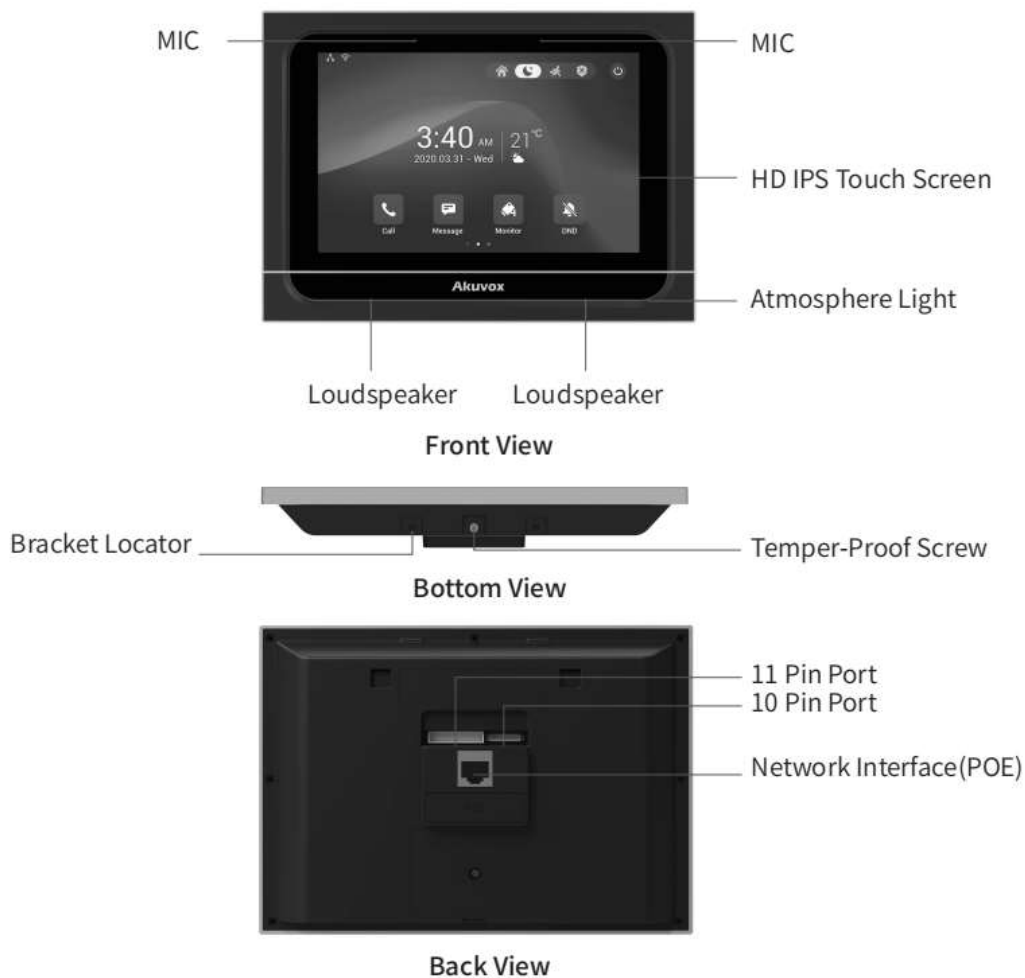

## Installation

### Step 1: Wall Bracket Installation

Without embedded junction box in the wall.

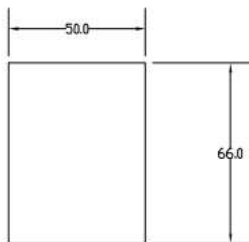

According to the position of the cable in the wall, cut a square hole (height\*width\*depth=66mm\*50mm\*55mm) in the wall used to accommodate all the cables.

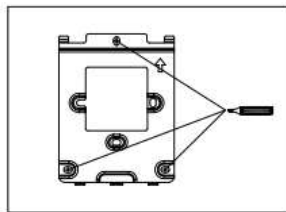

Align the square hole of the wall bracket with the hole on the wall and then mark the three fixing holes of the bracket on the wall.

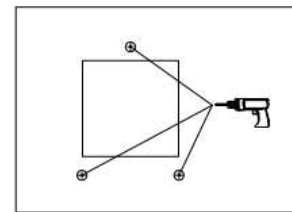

Take off the bracket and drill the three marked holes on the wall. (5mm in diameter and 25mm in depth)

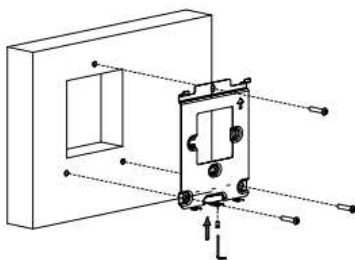

Drive the M3 set screw into the hole in the bottom center of the bracket using Allen wrench attached and make sure that the tail-end of the screw is flushed with the hole surface of the bracket, then fix the bracket on to the wall using three ST4x20 crosshead screws.

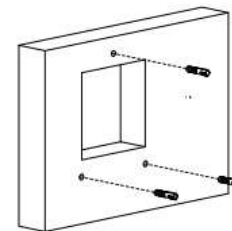

Insert the plastic wall anchors attached into the drilled holes.

With embedded one-gang junction box (86x86mm) in the wall.

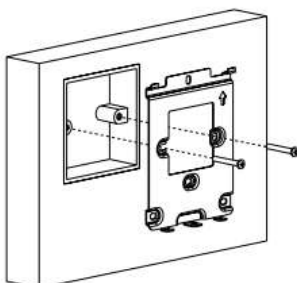

Fix the wall bracket on to the junction box using two M4x30 screws.

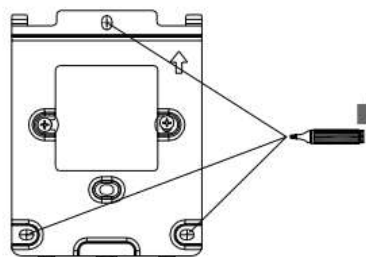

Mark the hole positions as indicated in the drawing.

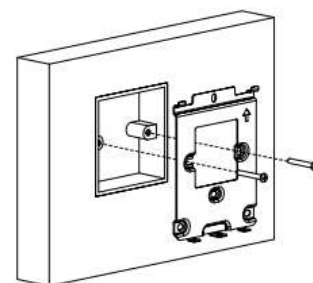

Take off the M4x30 screws along with the wall bracket.



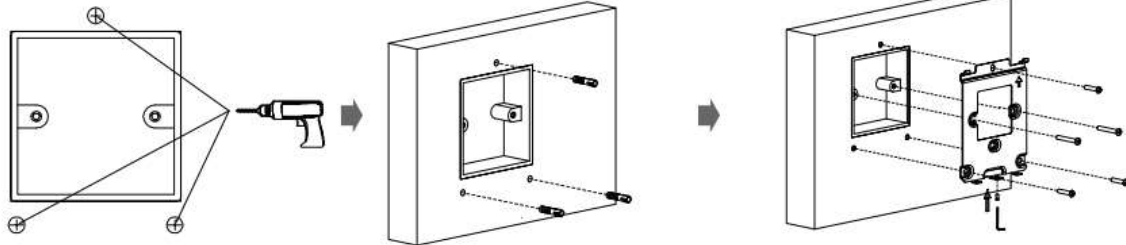

Drill three holes on the marked hole positions. (5mm in diameter and 25mm in depth)

Insert the plastic wall anchors into the three drilled holes.

Drive the M3 set screw into the hole in the bottom center of the bracket using Allen wrench attached and make sure that the tail-end of the screw is flushed with the hole surface of the bracket, then fix the bracket on to the wall using three ST4x20 crosshead screws and two M4x30 screws.

## Step 2: Device mounting

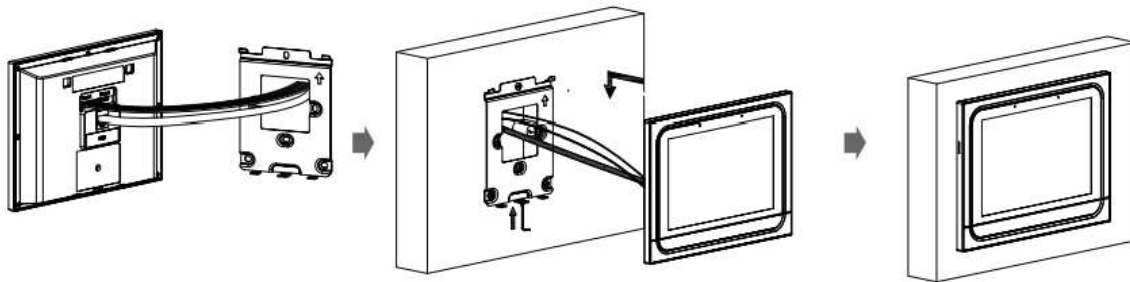

Connect the network cable and signal cable to their corresponding interfaces at the back of the device.

Hang the device on to the square hooks on the wall bracket using the two square holes at the back top of the device, and keep the device parallel to the wall before tightening the bracket using M3 set screw.

The installation is completed.

## Device Wiring

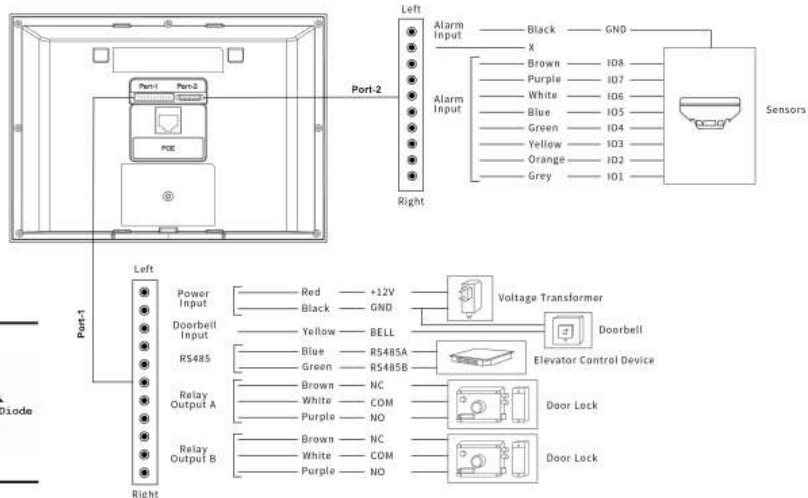

### Warning

When you connect a device containing a coil, such as a relay or an electromagnetic lock, it is necessary to protect the intercom against voltage peak while switching off the induction load. For this way of protection we recommend a diode 1 A / 200 V (included in the accessories) connected antiparallel to the device.

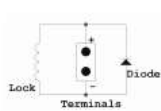

## Basic Configuration

### Device Initialization:

- (1) Power on the device, and start device initialization.
- (2) Select your language, then press **Next**.
- (3) Select your time zone, then press **Next**.
- (4) Select your internet connection via Ethernet or Wi-Fi, then press **Done**, then **Next**.
- (5) Press  to enable the X933H to start pairing with Zigbee devices that have been set up in the Akuvox Cloud.
- (6) Reset the Zigbee device to pairing mode and wait until the device is paired with the X933H successfully. **Note:** Please refer to the Zigbee device manual for the pairing operation.
- (7) Press the Zigbee device icon on the screen, and press **Next**, and you will see the Zigbee device connection successfully.



**Note:** All the Zigbee device(s) synchronized from the Akuvox Cloud have to be added on the X933H before you can finish the device initialization. After the initialization, you are allowed to add extra Zigbee devices in **Home Automation** interface if needed.

**Access basic information:** After finishing the device initialization, swipe left on the home screen and press **Settings** icon to go to **System Info** where you can check for Account, Network, version status etc.



**Access the web interface:** Enter the device IP address in a browser and press **Enter**, then enter the username and password to log in the device web interface. (The username and password are all **admin** by default in your initial login)

## Operation

### Make a call:

Enter the callee's number, then press **Dial**  icon to make an audio call or press video camera  icon to make a video call. Press  icon to hang up.

### Receive a call:

Press  icon to pick up the incoming call in video mode or press  to pick up the call in audio mode.

### Unlock:

During the talk, you can press the **Unlock**  icon on the talking screen to unlock the door.

### Monitor:

Press the **Monitor**  icon to receive the video from the door phone or from third-party devices.

### Notice Information

Akuvox X933H firmware contains third-party open source software under the terms of the GNU General Public License (GPL). Akuvox is committed to meeting the requirements of the GNU General Public License (GPL) and will make all required source code available. The source code of software under the terms of GNU GPL can be downloaded online, <http://www.akuvov.com/gpl>.

Information contained in this document is believed to be accurate and reliable at the time of printing. This document is subject to change without notice, any update to this document can be viewed on Akuvox's website: <http://www.akuvov.com> © Copyright 2021 Akuvox Ltd. All rights reserved.



**AKUVOX (XIAMEN) NETWORKS CO., LTD.**

ADD: 10/F, NO.56 GUANRI ROAD, SOFTWARE PARK II, XIAMEN 361009, CHINA  
[www.akuvov.com](http://www.akuvov.com)



YS93300004

